

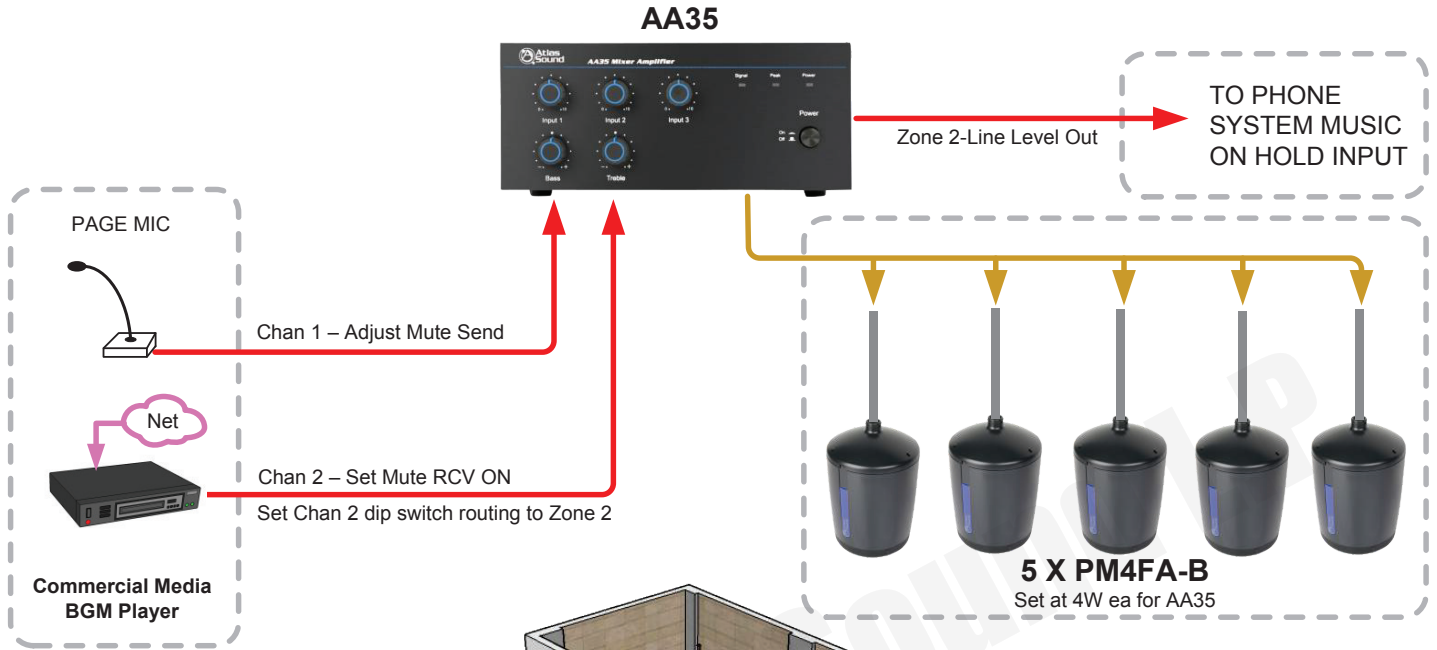

Coffee Shop Sound System with Voice Page and Music On Hold

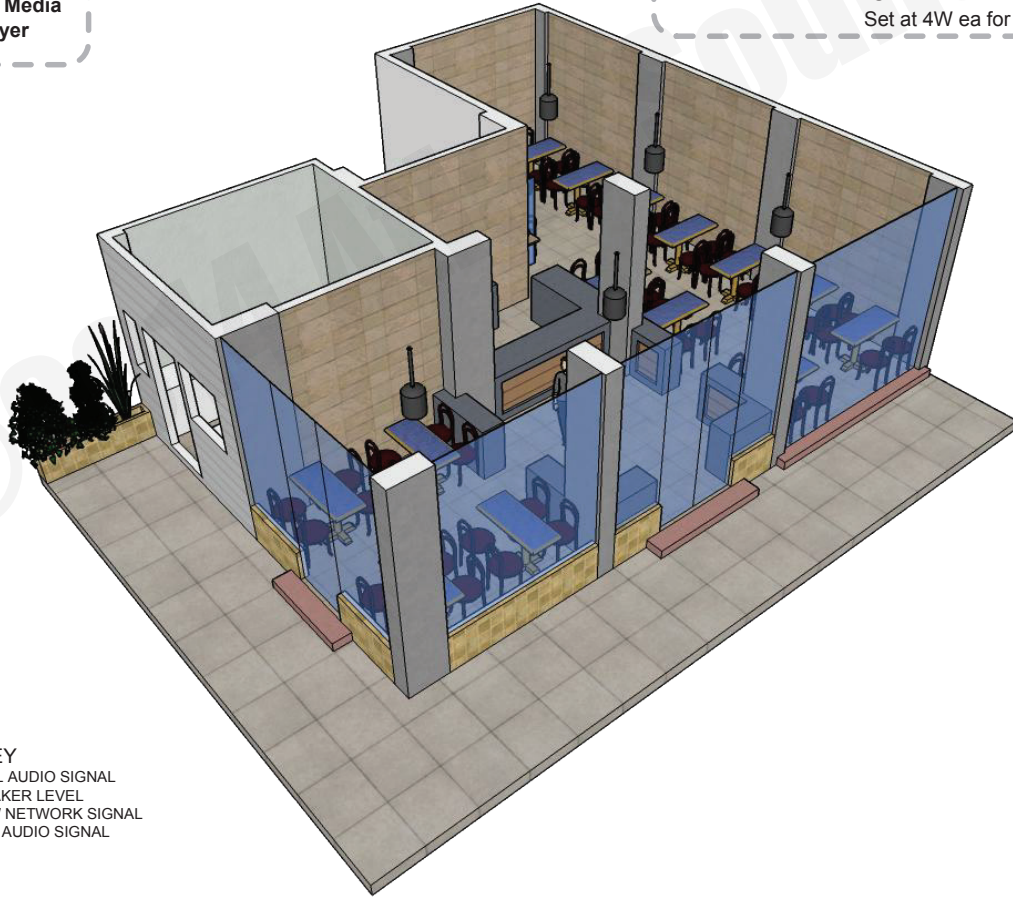

©2014 Atlas Sound L.P. All rights reserved. Atlas Sound is a trademark of Atlas Sound L.P. All other trademarks are property of their respective owners. AT5005036 RevA 10/14



- LINE COLOR KEY**
- LINE LEVEL AUDIO SIGNAL
 - LOUDSPEAKER LEVEL
 - CONTROL / NETWORK SIGNAL
 - MIC LEVEL AUDIO SIGNAL
 - VIDEO
 - GROUND
 - 120V

This is a design concept and is not meant to be a fully engineered system design. Contact Atlas Sound for system design help.



1601 Jack McKay Blvd. • Ennis, Texas 75119 U.S.A.
Telephone: 800.876.3333 • Fax: 800.765.3435



Overview:

This example illustrates a simple Coffee Shop background music system with one (1) commercial media player and one (1) countertop-paging microphone connected to a mixer amplifier. The mixer amplifier mixes the two sources to the pendant speakers and also feeds a line level audio signal to the music-on-hold phone system input. The mixer amplifier allows priority paging to automatically lower the music volume on the pendant speakers whenever using the paging microphone. Music automatically returns to the mix level after the page is completed.

Application Example Description:

In this example, a commercial media player and countertop-paging microphone provide two sources for an AA35 70V amplifier. The AA35 powers five (5) PM4FA-B pendant speakers suspended from a plaster ceiling with each tap setting at 4-watts. The rear panel dipswitches allow the zone-2 source to use channel 2 (music) and the output is then connected to the MOH (music-on-hold) phone system input and adjusted for clean sound. The mixer amplifier priority page feature is used to lower the level of the music automatically whenever the paging microphone is used. The rear panel dipswitch panel has a mute RCV function that can be set on the channel the music source is connected to, in this example channel 2, then while playing music at the day to day level, speak into the paging microphone in a normal voice and adjust the Mute Sens pot on the rear of the amplifier until the music muting is working at the desired level.

Benefits:

- Cost Effective BGM-Priority Paging System
- Modern Pendant Speakers Enhance Decor
- Promotes An Inviting Environment

©2014 Atlas Sound L.P. All rights reserved. Atlas Sound is a trademark of Atlas Sound L.P. All other trademarks are property of their respective owners. AT5005036 RevA 10/14

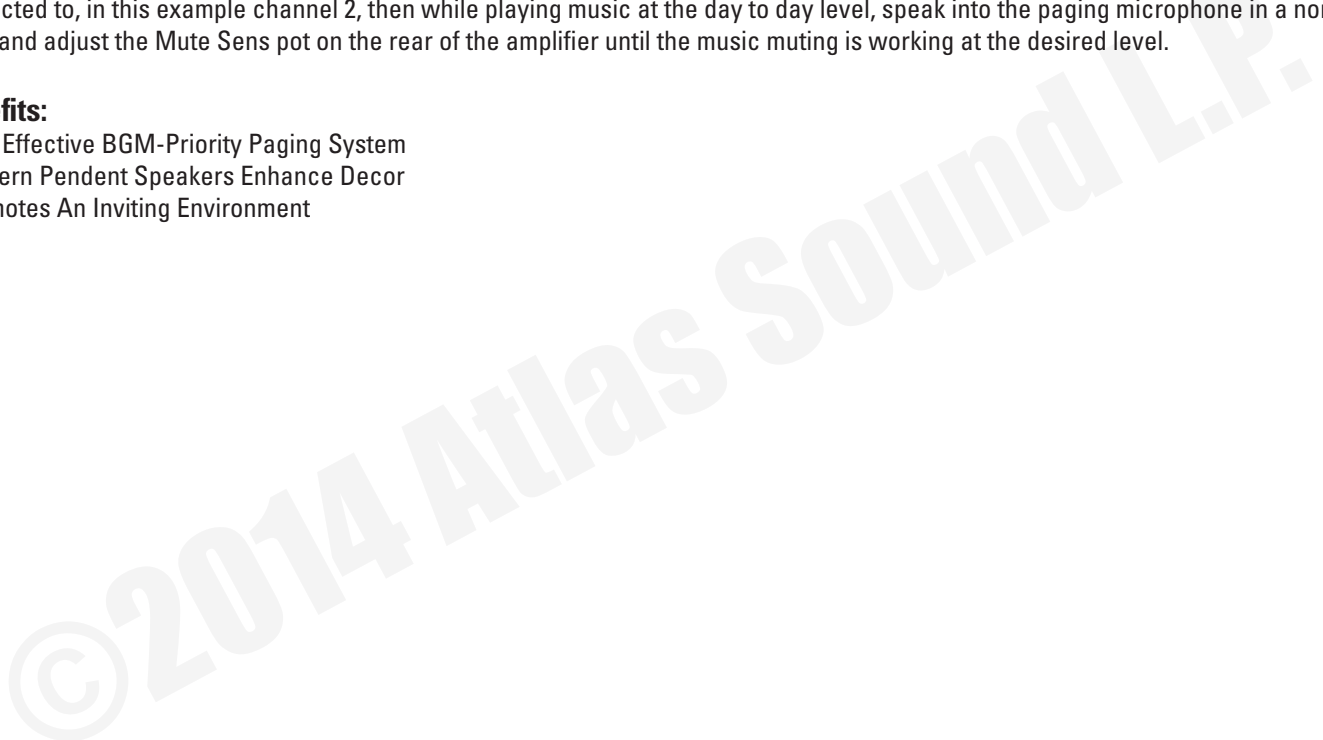

1601 Jack McKay Blvd. • Ennis, Texas 75119 U.S.A.
Telephone: 800.876.3333 • Fax: 800.765.3435